

17th Annual Meeting of Intelsat Retirees and Alumni Association

16 October 2016



Agenda



- ✓ Adoption of the Agenda
- ✓ Report on the Results of Election for Three Directors & Election of Board Officers
 - ✓ Membership Status Report
 - ✓ Report on Association Finances
 - ✓ Report on Health & Retiree Benefits



- ✓ **Social Event Planning**
- ✓ **Other Business**
- ✓ **Adjournment**
- ✓ **Guest Speaker - Sima Fishman**
 - ✓ **Buffet**



Adoption of the Agenda



Report on the Election Results & Election of Board Officers



3 Directors Re-Elected

(term expiring in Oct. 2018)

- **Simon Bennett**
- **Jane Kinzie**
- **Alan Olson**



IRAA

Board Members & Volunteers



President

Peggy Slye

Vice-President

Simon Bennett



Directors

Simon Bennett

Jane Kinzie

Alan Olson

Bob Peters

Peggy Slye



Administrative Assistant

Please volunteer

Chairperson Social Committee

Ati Kadarmanto-Olson

Facebook Administrator

Ed Stoner



Membership Co-Directors

Alan Olson

Ed Stoner

Newsletter Editor

Jane Kinzie

Newsletter Editor Assistant

Please volunteer



Secretary

Anita Saltos

Treasurer

Satpal (Rani) Chhabra

Special Advisor to the Board of Directors

D.K. Sachdev

Website Manager

Alan Olson



Social Committee

Ati Kadamanto-Olson

Anita Saltos

Ed Stoner

Alan Olson



Welcome New Members



October 2016

**Anthony Busog
David Wootten**

August 2016

**Derek Drummie
Pat Gilligan**

June 2016

Flavian Bachabi



April - May 2016

Tony Berntzen

Sue Decker

John Hsing

Ati Kadarmento-Olson

Tom Kombo

Angela Kummel

Sin-Ya (Cindy) Liu

Sheela Pinto

Robert Lambert

Norm Ronquillo



March 2016

**Richard (Greg) Marlow
Sanjay Singhal**

January 2016

Rachel Devaux-Jeffries



Lost Intelsat Colleagues



Kitty Horer



25 September 2016

Jack Dicks



10 August 2016



Peter Schultze



7 July 2016



Jim Owens



11 May 2016



Lucille Ferrandino

(surviving spouse of Peter)

9 April 2016



Gunnar Rosell

2016



Raymond Tourtilott

2016



John Sherbird

February 2016



Membership Status



Total membership: 382

- 18 new members
- 8 lost members
- 3 resigned members (Alumni)

• **Active members: 338**

- Lifetime: 47
- Five-Year: 144
- Annual Regular: 127
- Other: 20
- Limited Rights: 10
- Inactive: 32
- Suspended (return to Intelsat): 2



▶ Country Breakdown:

▶ USA	344
▶ France	6
▶ United Kingdom	6
▶ Australia	5
▶ Brazil	2
▶ Germany	2
▶ India	2
▶ Thailand	2
▶ Bermuda	1



▶ Country Breakdown (contd):

- ▶ Canada 1
- ▶ Greece 1
- ▶ Ireland 1
- ▶ Italy 1
- ▶ Japan 1
- ▶ Netherlands 1
- ▶ Norway 1
- ▶ South Africa 1
- ▶ Spain 1
- ▶ Sweden 1



▶ USA/State Breakdown:

▶ United States - **343** (*East 296; West 42; Mid-West 5*)

▪ MD	121	AZ	4	DE	1
▪ VA	104	WA	4	IA	1
▪ FL	24	NV	3	MA	1
▪ CA	23	GA	2	MI	1
▪ DC	18	IN	2	NE	1
▪ NC	7	ME	2	NM	1
▪ CO	6	NJ	2	PA	1
▪ SC	5	NY	2	UT	1
▪ WV	5	TN	2	??	2



**Please remember
to let us know:**



- **If you have a change of address, phone number, or EMail address; or if you may be aware of a recent loss of an Intelsat colleague:**

EMail to: info@myiraa.com

- **If you have any significant life-change event such as a loss of a spouse:**

Contact Intelsat Benefits Call Center toll free:

[1-877-632-8108](tel:1-877-632-8108); [001-877-632-8108](tel:001-877-632-8108) (International)

Also EMail to: info@myiraa.com



IRAA & Friends Facebook

(closed group)



▶ **Total membership: 258**

- **To join IRAA&F closed group:**

<https://www.facebook.com/groups/IntelsatRetirees/Association>

- or go to website: www.myiraa.com

- **For assistance in joining the IRAA&F, EMail our
FB Administrator, Ed Stoner, info@myiraa.com**



Report on Association Finances



Report on Health & Retiree Benefits



- **Industry and Analyst Reports About Intelsat**
- **Reporting a Life Changing Event**
- **“Grandfathered Health Plans” vs ACA**
- **“Creditable Coverage” for Prescription Medications**
- **PBGC Support for Single and Multi-Employer Pension Plans**



16th Annual Meeting of Intelsat Retirees and Alumni Association)

18 October 2015

▪44 participants

















Social Activities 2016



Five Events This Year



Tour of Intelsat New HQ Building

15 January 2016

- 26 participants

23 February 2016

- 10 participants







L to R: Tequamech & Getachew Tadesse, Diane & Dennis McCarthy, Danielle Edgell, Maria Fernanda Delgado, Rodica Samata, Roland & Rosa Liu, Tony Russo, Angella Farserotu & Fatmata Cherif, Shobha & Raju Chidambaram, Dai Rees, Donald Edgell, Michelle Crown, Hany Eldeib, Guibin Dong, Sen Dan, Mike Mohajeri, Dave Burks; Not Pictured: Lucky Faisano, Ceferino Rodriguez, Julietta & Mike Wiseman





L to R: Ruth Kuperschlag, Stephanie & Fernando Van Regiersberg, Olivia Chattin, Wayne Wu, Marvin Arluk, Victor Slabinski, Dave & Nancy Kennedy, Ildemaro Rueda



Remember this place?



7th Annual Outing at Strathmore

Vivaldi's Gloria- 21 Feb. 2016

- **8 members/guests from COMARA/IRAA**





7th Annual Summer Picnic

Seneca Creek State Park - 22 May 2016

- **102 members/guests from COMARA/IRAA & Intelsat**
(up from 76 last year despite the cool, wet, cloudy weather)



































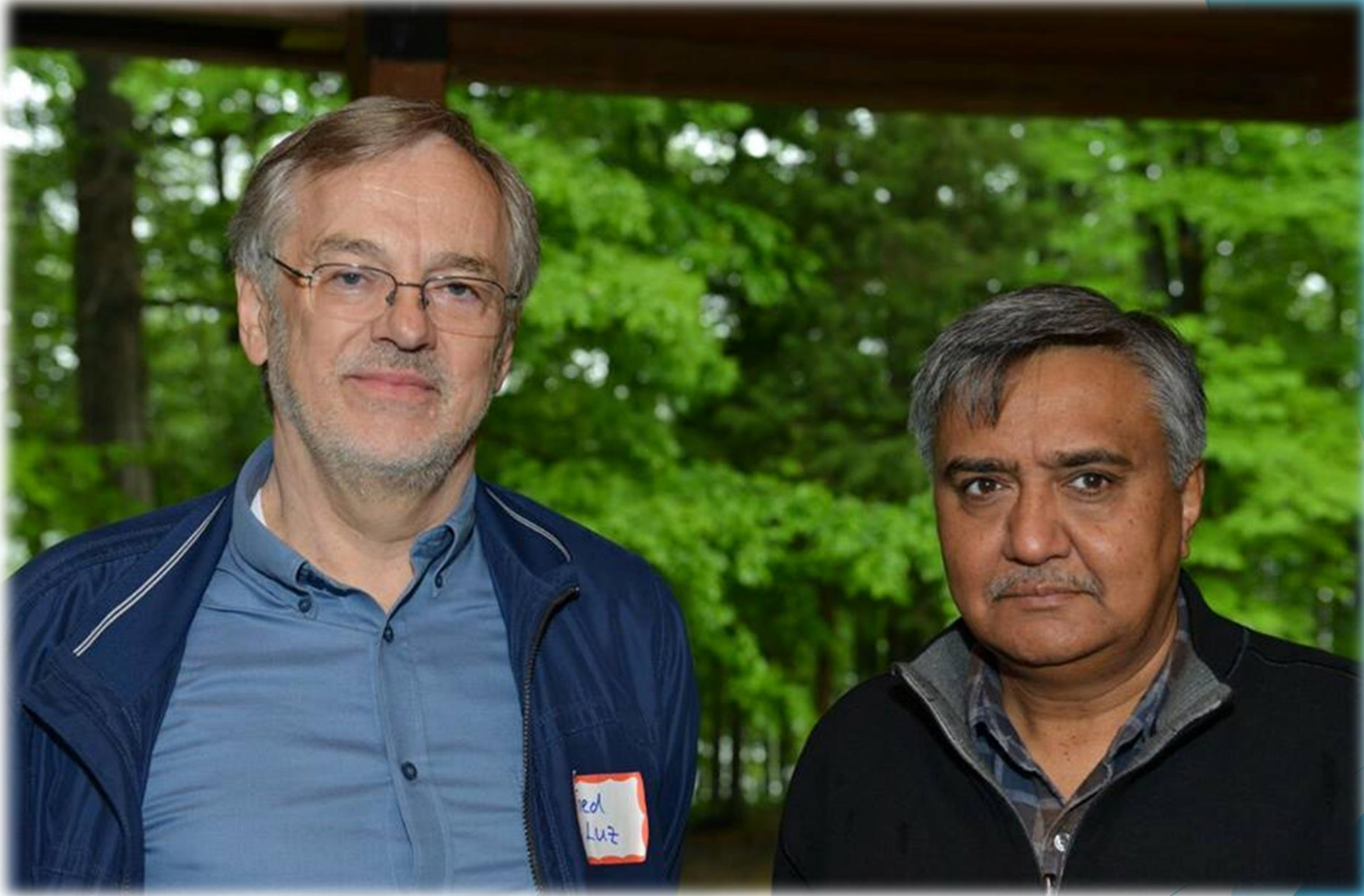































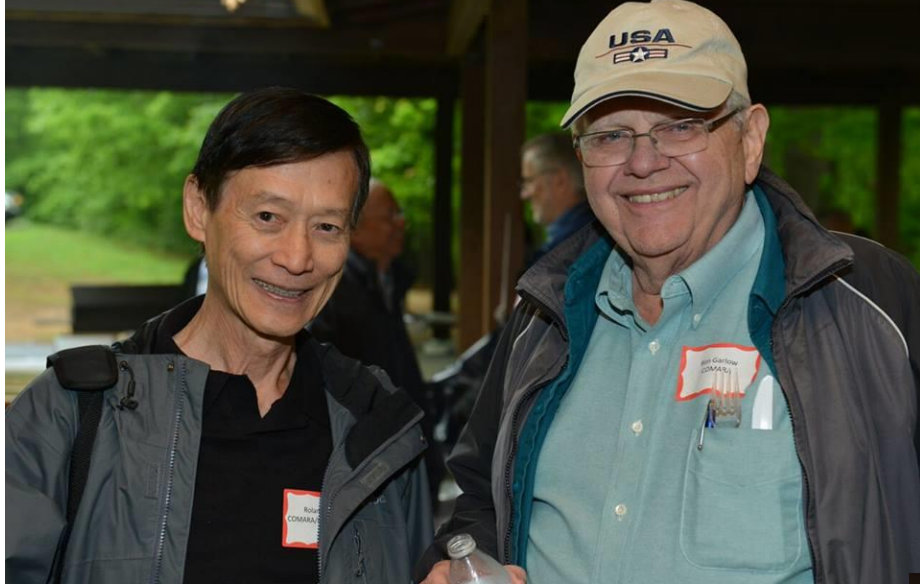



Golf Outing

MCGC Falls Road Golf Course

25 August 2016

- **9 members/guests from IRAA & former Intelsat**















Wine Outing

Via Reston Limousine

Two Wineries in Loudoun County:

Barrel Oaks & Desert Rose

18 September 2016

- **6 members/guests from IRAA**







What's Happening Next Year?



Winter Social Get Together

Member Residence TBD

Late January 2017, Date/Time TBD

- Catered food/drinks
- Member contribution TBD

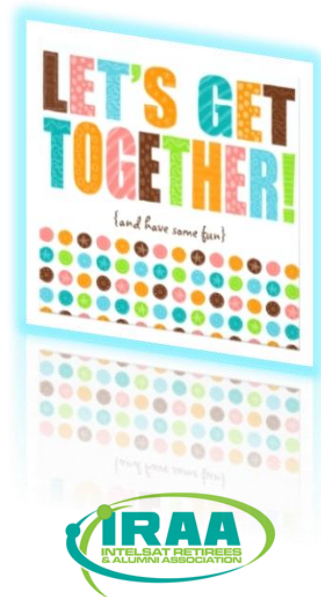

8th Annual Outing at Strathmore

National Philharmonic:

Rachmaninoff's Piano Concerto No. 2



- Sunday, Jan. 29, 2016, 3pm

-or-

National Philharmonic:

Mussorgsky's Pictures at an Exhibition

- Sunday, Apr. 23, 2016, 3pm



8th Annual Summer Picnic

Seneca Creek State Park, *Buck Pavilion*

- Sunday, May. 21, 2017, 12pm - 4PM

-And-

Wolf Trap Filene Center

Event TBD pending release of summer schedule next Spring



2nd Annual Golf Outing

Venue Pending TBD

- **Date/time pending TBD in September 2017**

***We hope you can join us in this fun event
whatever level your game - the more the merrier!***



We hope to

**SEE YOU
NEXT YEAR!**

at some of these events that the
Social Committee is planning.

Thank you!



Please let us know if you have any suggestions for a social event you would like the Social Committee to look into setting up next year.



Email:

info@myiraa.com



Other Business



National Electronics Museum



“Satellites: Transforming Our Lives Exhibit”



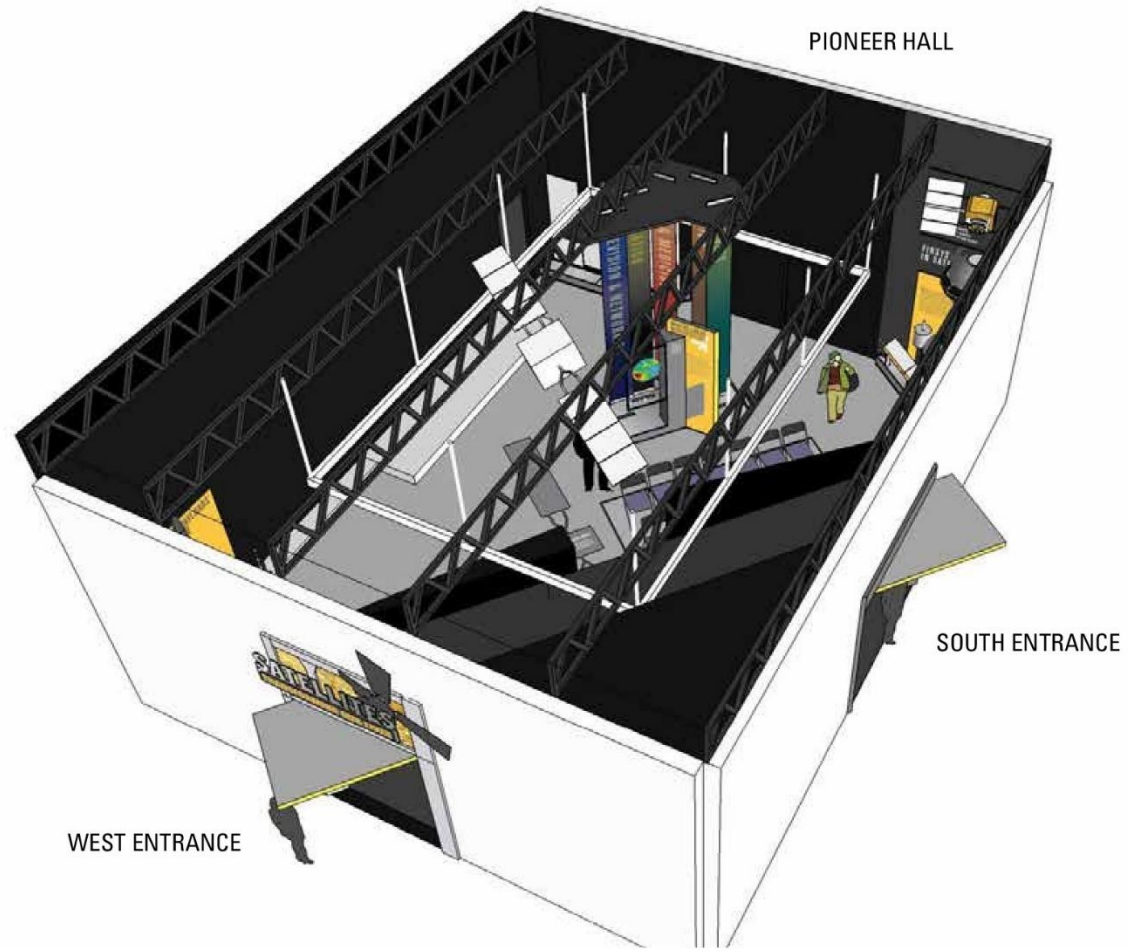

OVERHEAD
Not to scale

dfdesign

CLIENT
National Electronics Museum

PROJECT
Satellites Gallery

DESCRIPTION
Design Development Phase, Progress Presentation at Hughes

DATE
14 September 2016

01



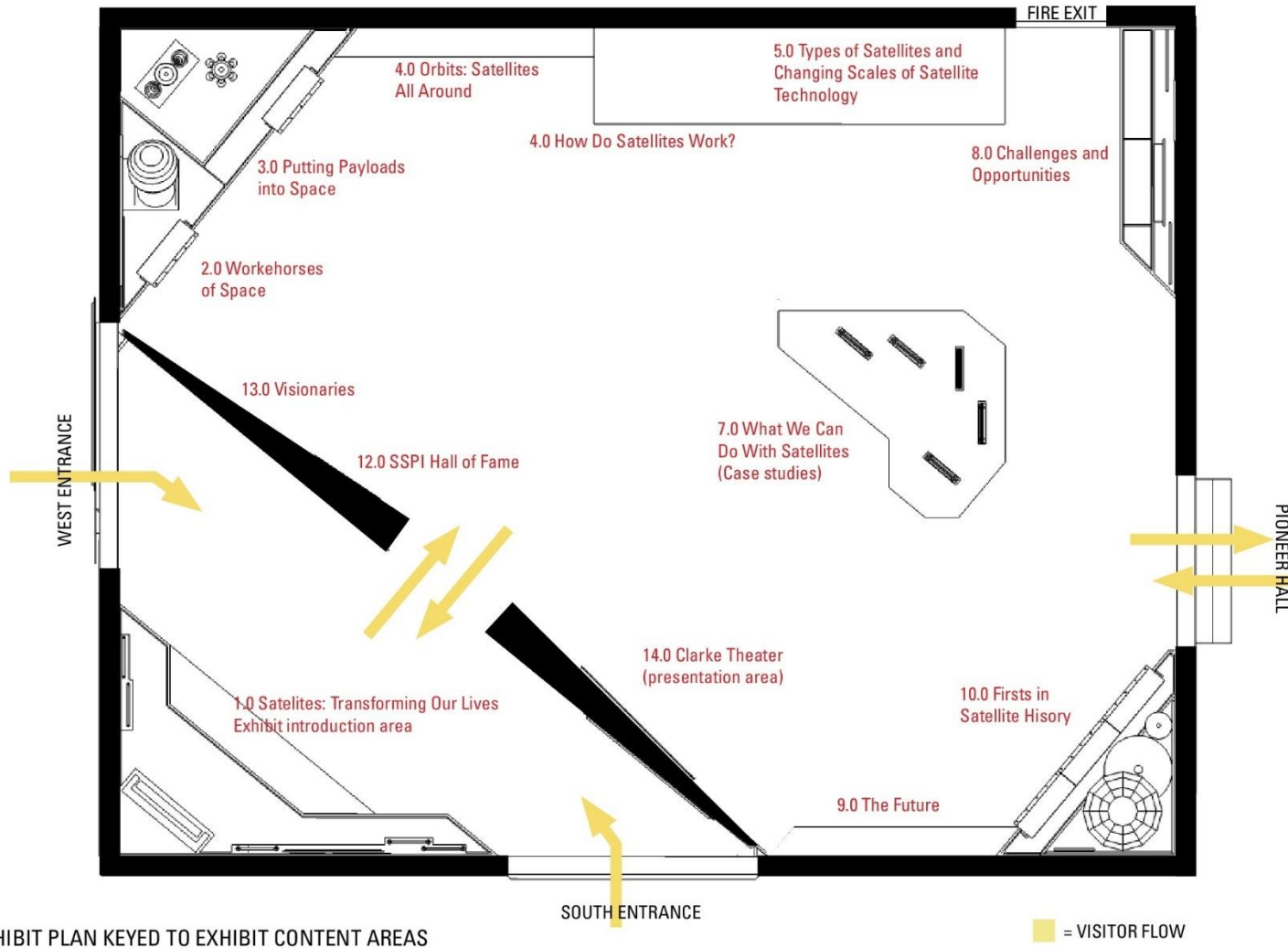

EXHIBIT PLAN KEYED TO EXHIBIT CONTENT AREAS

Not to scale

dfdesign

CLIENT
National Electronics Museum

PROJECT
Satellites Gallery

DESCRIPTION
Design Development Phase, Progress Presentation at Hughes

DATE
14 September 2016

02





WEST ENTRANCE

Not to scale

dfdesign

CLIENT
National Electronics Museum

PROJECT
Satellites Gallery

DESCRIPTION
Design Development Phase, Progress Presentation at Hughes

DATE
14 September 2016

03





WEST ENTRANCE

Not to scale

dfdesign

CLIENT
National Electronics Museum

PROJECT
Satellites Gallery

DESCRIPTION
Design Development Phase, Progress Presentation at Hughes

DATE
14 September 2016

04





SOUTH ENTRANCE

Not to scale

dfdesign

CLIENT
National Electronics Museum

PROJECT
Satellites Gallery

DESCRIPTION
Design Development Phase, Progress Presentation at Hughes

DATE
14 September 2016

05



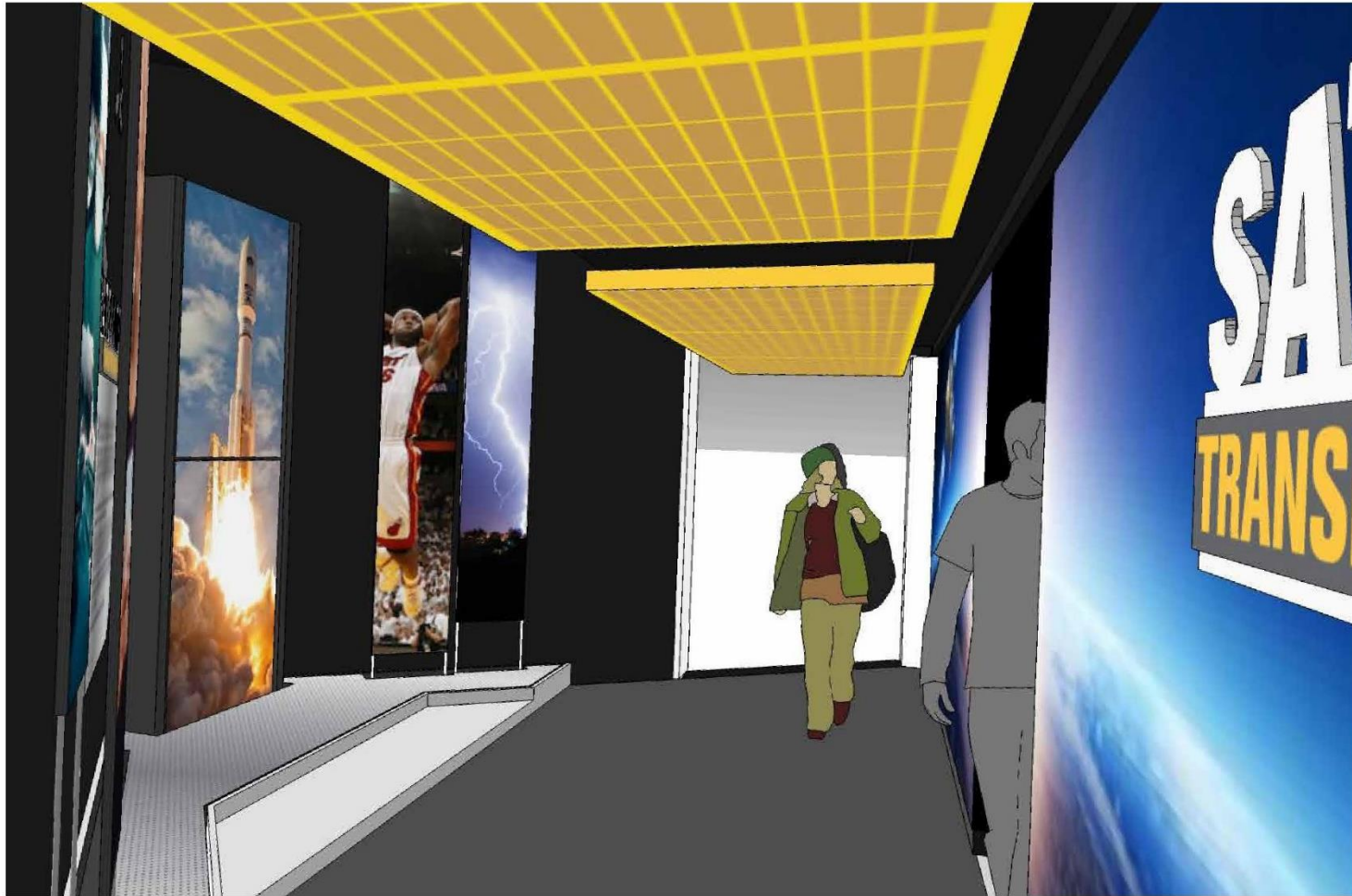

INTRODUCTION AREA FROM SOUTH ENTRANCE

Not to scale

dfdesign

CLIENT
National Electronics Museum

PROJECT
Satellites Gallery

DESCRIPTION
Design Development Phase, Progress Presentation at Hughes

DATE
14 September 2016

06





INTRODUCTION AREA FROM WEST ENTRANCE

Not to scale

dfdesign

CLIENT
National Electronics Museum

PROJECT
Satellites Gallery

DESCRIPTION
Design Development Phase, Progress Presentation at Hughes

DATE
14 September 2016

07





INTRODUCTION AREA, CENTER VIEW WITH ROCKET LIFT-OFF VIDEO AND SOUND

Not to scale

df design

CLIENT
National Electronics Museum

PROJECT
Satellites Gallery

DESCRIPTION
Design Development Phase, Progress Presentation at Hughes

DATE
14 September 2016

08





MAIN GALLERY ENTRANCE VIEW

Not to scale

dfdesign

CLIENT
National Electronics Museum

PROJECT
Satellites Gallery

DESCRIPTION
Design Development Phase, Progress Presentation at Hughes

DATE
14 September 2016

09





CENTRAL CASE STUDIES FEATURE DISPLAY AND INTERACTIVE

Not to scale

dfdesign

CLIENT
National Electronics Museum

PROJECT
Satellites Gallery

DESCRIPTION
Design Development Phase, Progress Presentation at Hughes

DATE
14 September 2016

010



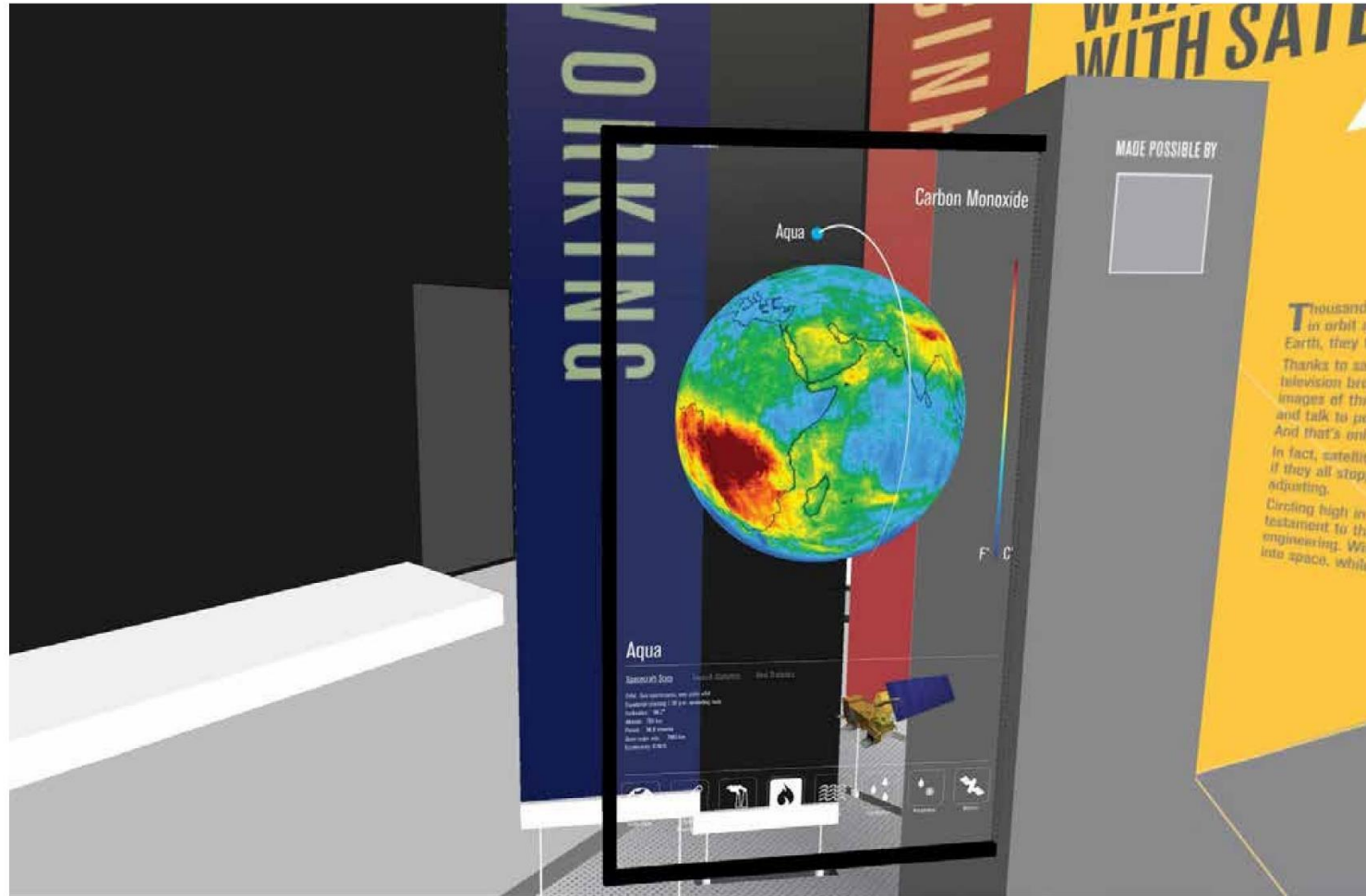

SATELLITE CASE STUDIES DISPLAY TRANSPARENT TOUCHSCREEN INTERFACE

Not to scale

dfdesign

CLIENT
National Electronics Museum

PROJECT
Satellites Gallery

DESCRIPTION
Design Development Phase, Progress Presentation at Hughes

DATE
14 September 2016

011





VIEW OF NW CORNER

Not to scale

dfdesign

CLIENT
National Electronics Museum

PROJECT
Satellites Gallery

DESCRIPTION
Design Development Phase, Progress Presentation at Hughes

DATE
14 September 2016

012





VISIONARY WALL AND SSPI HALL OF FAME TOUCHSCREEN DISPLAY

Not to scale

dfdesign

CLIENT
National Electronics Museum

PROJECT
Satellites Gallery

DESCRIPTION
Design Development Phase, Progress Presentation at Hughes

DATE
14 September 2016

013





SE VIEW OF CLARKE THEATER AREA

Not to scale

dfdesign

CLIENT
National Electronics Museum

PROJECT
Satellites Gallery

DESCRIPTION
Design Development Phase, Progress Presentation at Hughes

DATE
14 September 2016

014





CLARKE THEATER AREA SET-UP OPTION FOR SEATED PRESENTATIONS

Not to scale

dfdesign

CLIENT
National Electronics Museum

PROJECT
Satellites Gallery

DESCRIPTION
Design Development Phase, Progress Presentation at Hughes

DATE
14 September 2016

015



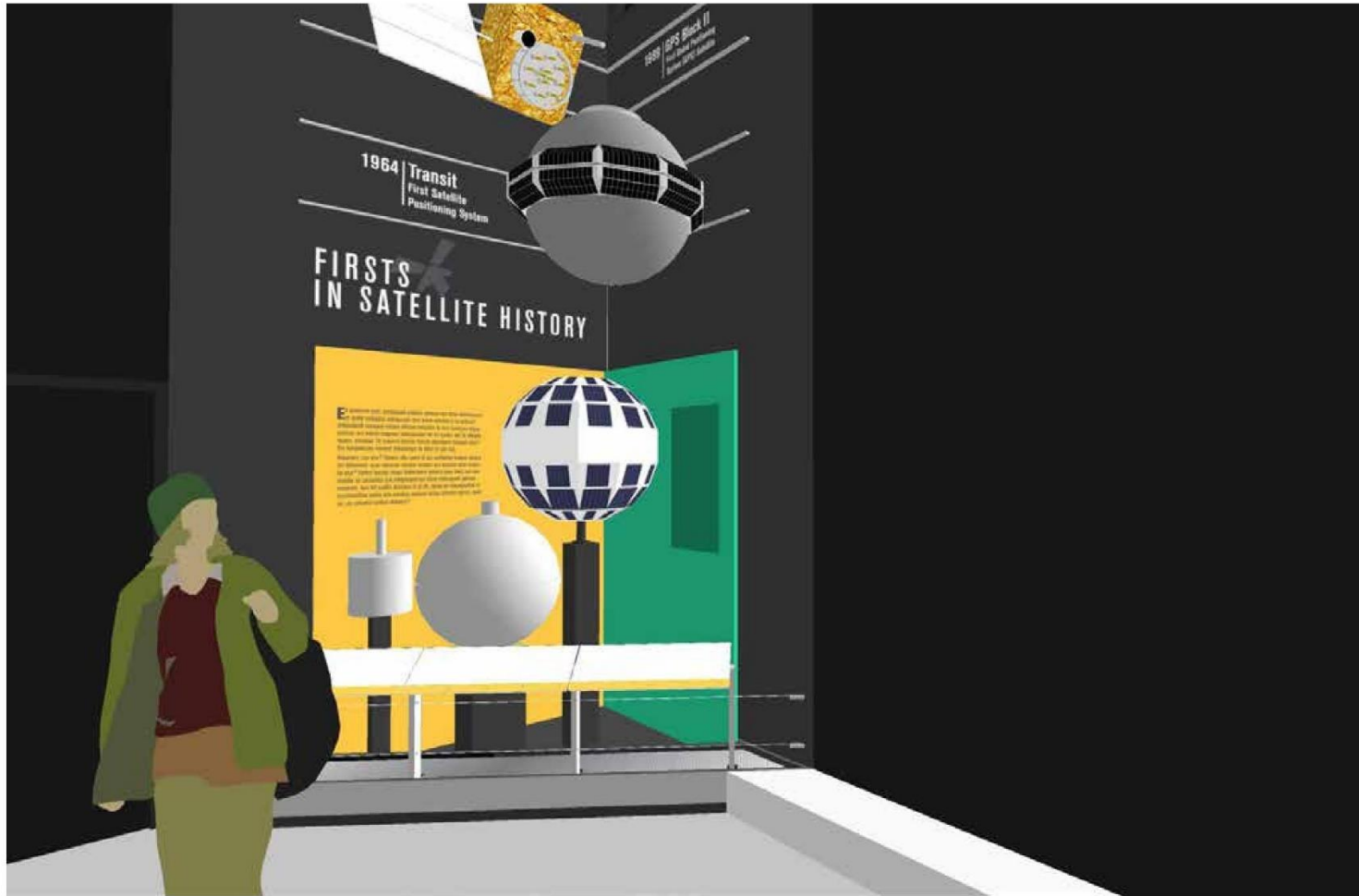

FIRSTS IN SATELLITE HISTORY DISPLAY AREA

Not to scale

dfdesign

CLIENT
National Electronics Museum

PROJECT
Satellites Gallery

DESCRIPTION
Design Development Phase, Progress Presentation at Hughes

DATE
14 September 2016

016



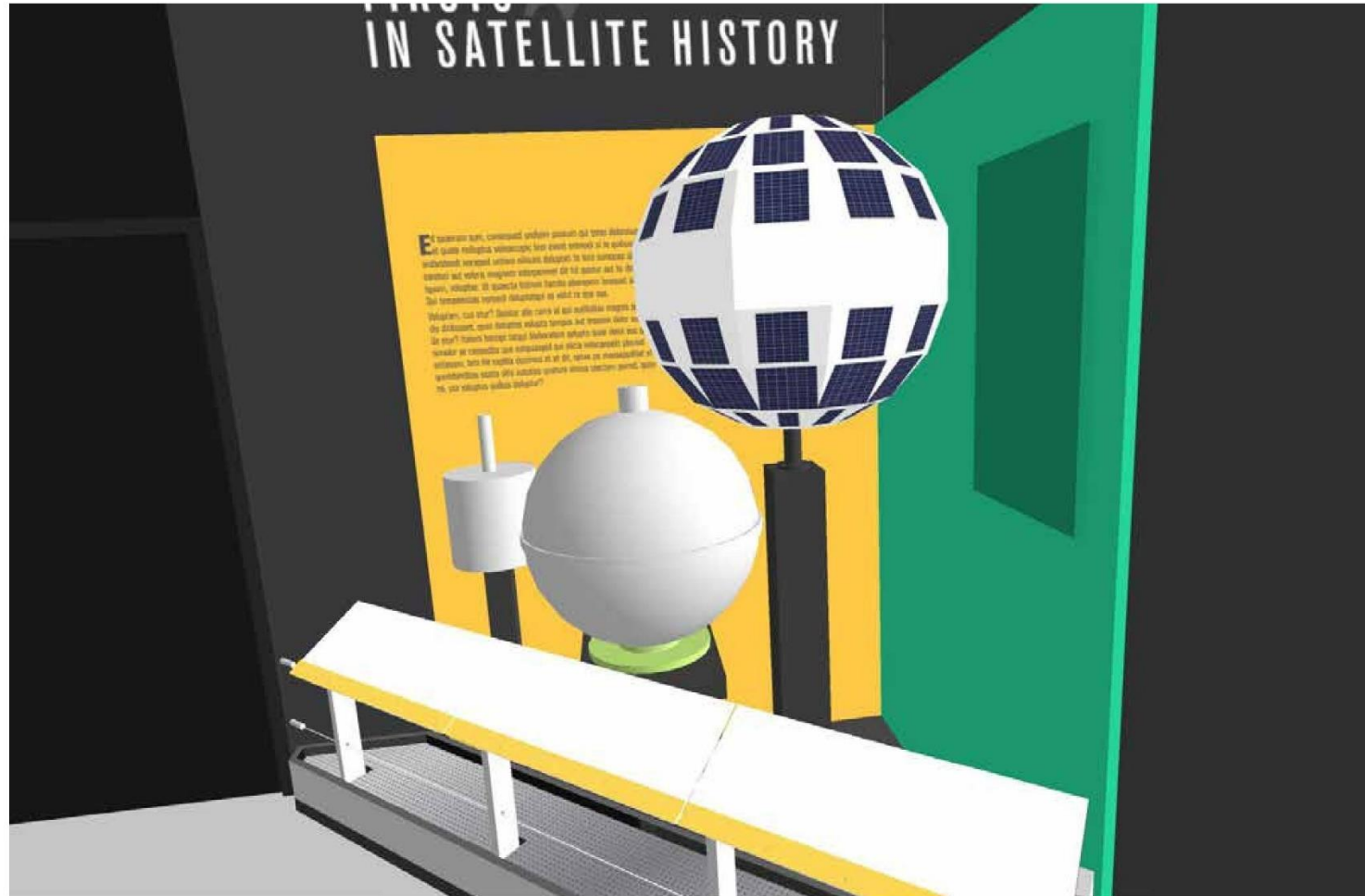

"FIRSTS" TIMELINE ALONG READER RAIL

Not to scale

dfdesign

CLIENT
National Electronics Museum

PROJECT
Satellites Gallery

DESCRIPTION
Design Development Phase, Progress Presentation at Hughes

DATE
14 September 2016

017





SATELLITE HISTORY DISPLAY WITH ASCENDING MODEL ARRANGEMENT AND WALL LABELS

Not to scale

dfdesign

CLIENT
National Electronics Museum

PROJECT
Satellites Gallery

DESCRIPTION
Design Development Phase, Progress Presentation at Hughes

DATE
14 September 2016

018





CLARKE THEATER

Not to scale

dfdesign

CLIENT
National Electronics Museum

PROJECT
Satellites Gallery

DESCRIPTION
Design Development Phase, Progress Presentation at Hughes

DATE
14 September 2016

019



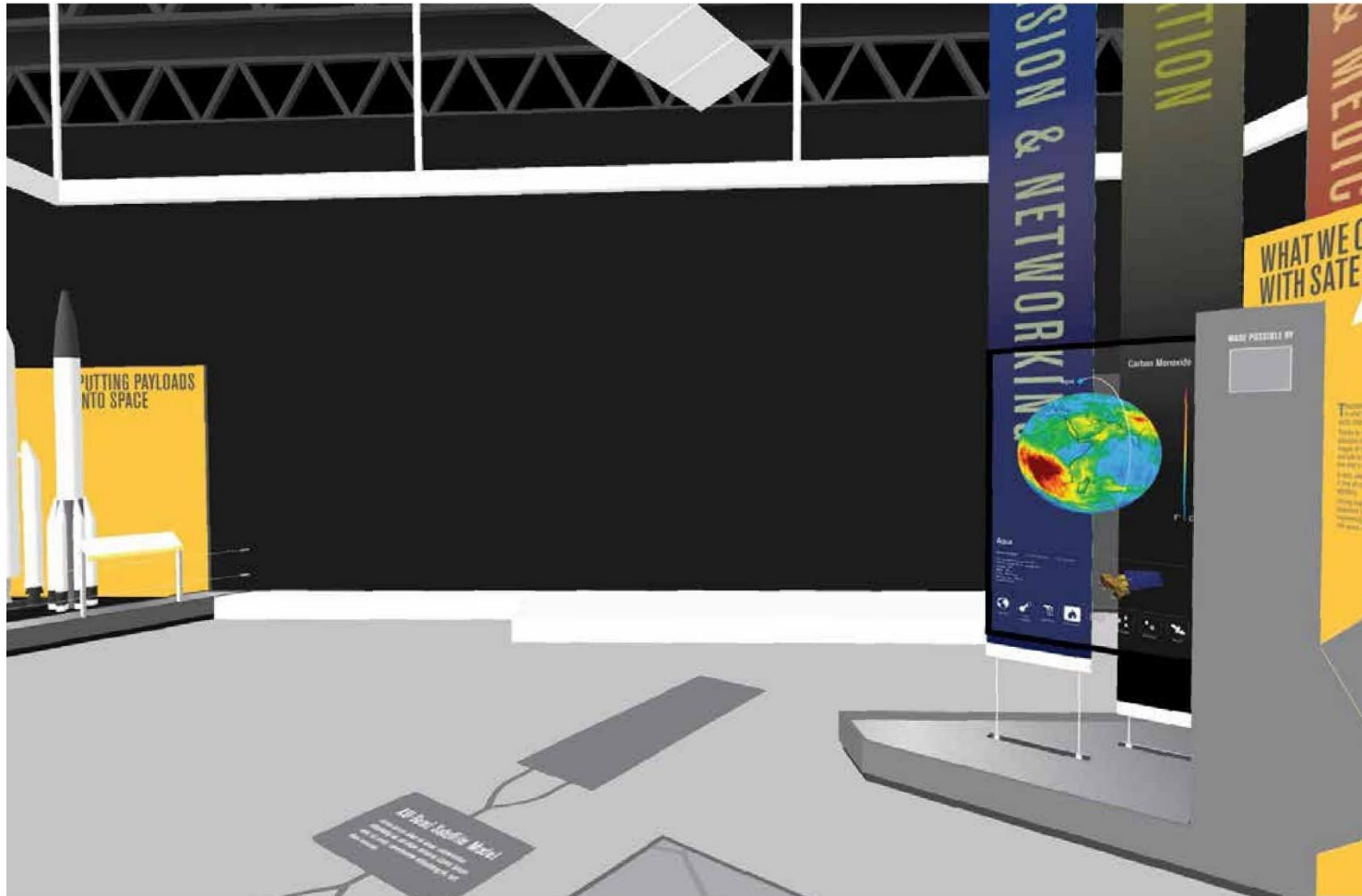

SCIENCE AND ENGINEERING OF SATELLITES AREA (UNDER DEVELOPMENT)

Not to scale

dfdesign

CLIENT
National Electronics Museum

PROJECT
Satellites Gallery

DESCRIPTION
Design Development Phase, Progress Presentation at Hughes

DATE
14 September 2016

020



**If you would like to make a donation
to the NEM for the
“Satellites: Transforming Our Lives Exhibit”**

<http://nationalelectronicmuseum.org>



Adjournment



Guest Speaker Sima Fishman

Managing Director,  USA





Smallsats: What are they Good For?

Presented by
Sima Fishman, Managing Director
Euroconsult USA

16 October 2016
Intelsat Retirees and Alumni Association meeting

Transformational nature of satcom “growth” phase



Current satcom business patterns are those of a **breakthrough innovation period**:

- New/more **cost-effective solutions** (satellite, ground) open new opportunities...
...but also result in oversupply and challenge legacy satellite services
- Flurry of **new projects** – but all the announced ones shall not happen. Some will still go through and can be game changers
- Higher **technology and business risk**
- More **diversity in the strategies** pursued by organizations in order to adapt their business offering

Forces at play in the Satcom sector

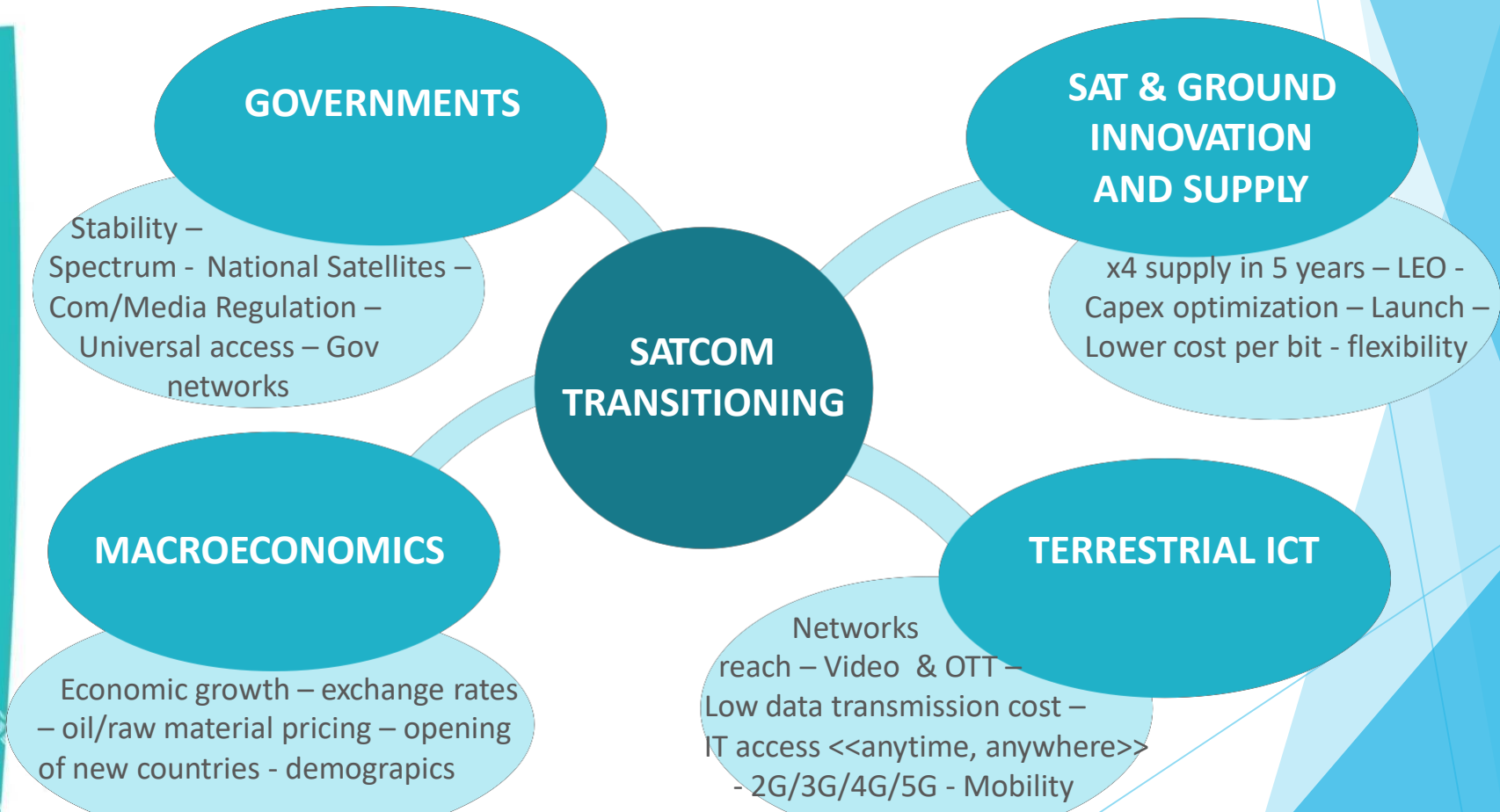

Bandwidth – demand taking a breath

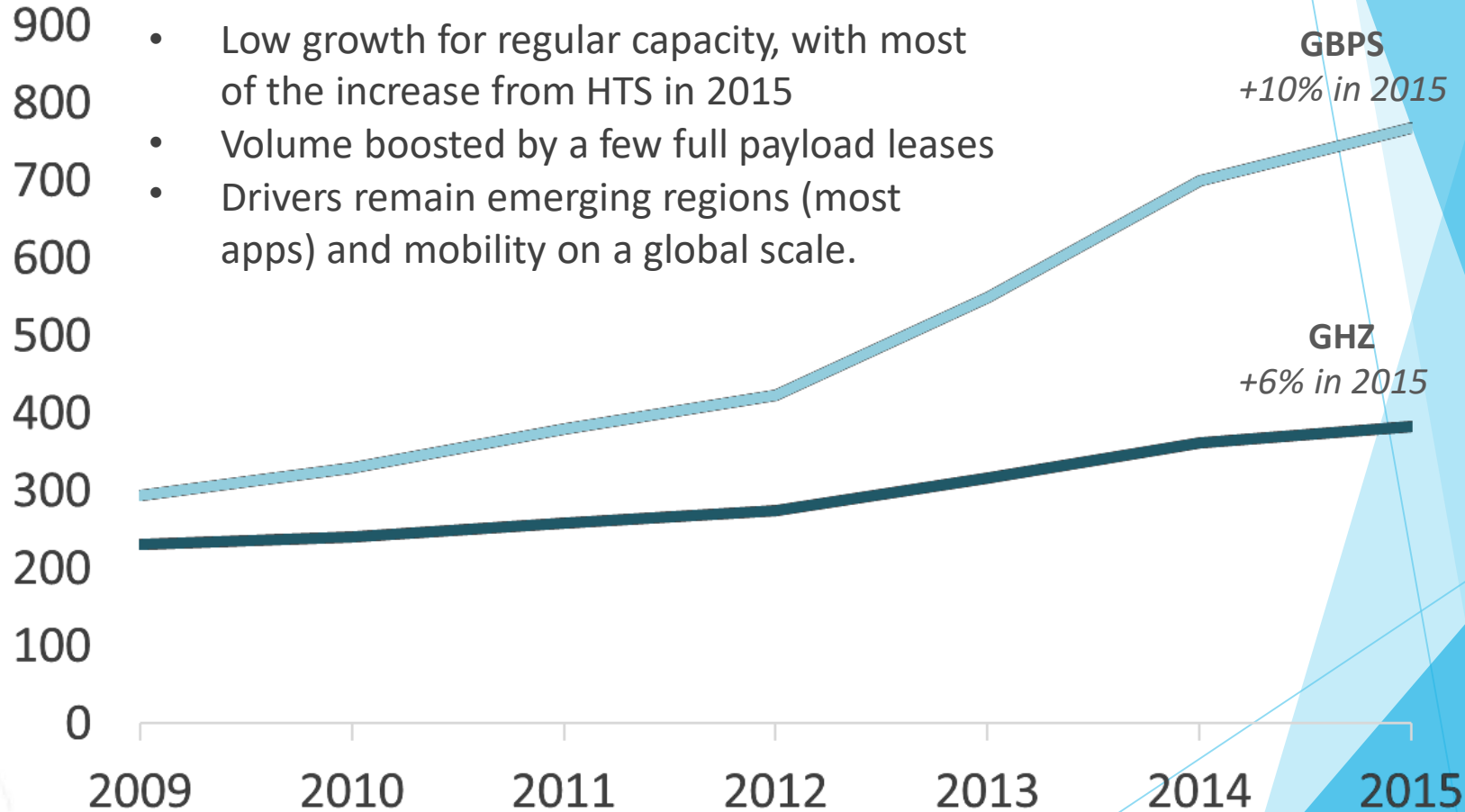

- Low growth for regular capacity, with most of the increase from HTS in 2015
- Volume boosted by a few full payload leases
- Drivers remain emerging regions (most apps) and mobility on a global scale.

The supply rollercoaster- what supply for 2020

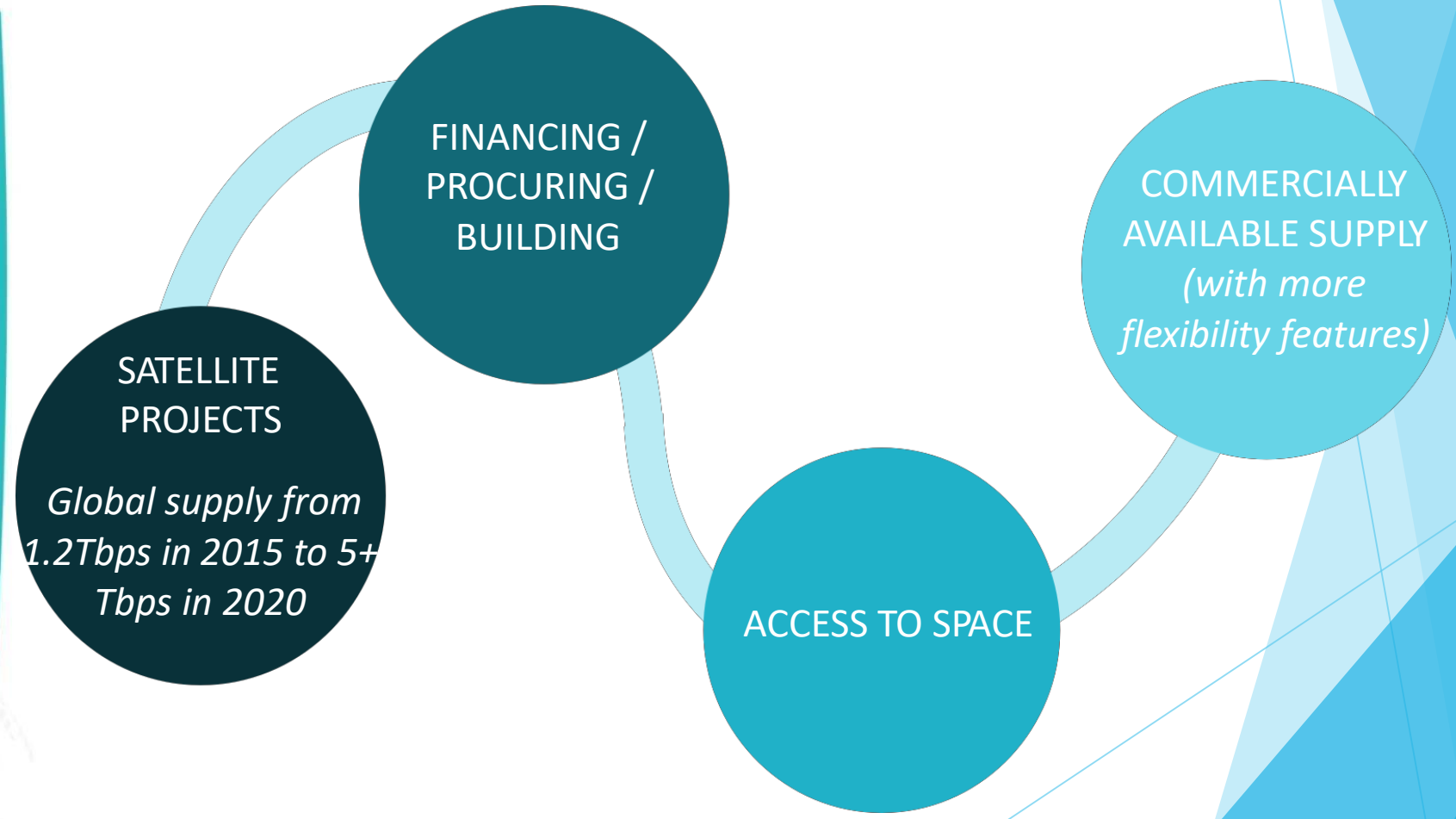

LEO and MEO Constellations



Multiple reported project holders and concepts of MEO and LEO broadband constellations

OneWeb – LeoSat – Telesat – SpaceX – Spacebelt – Laser Light – Eighty-LEO – Yaliny – Xinwei Telecom – Outernet etc.

We expect the main impact of new projects to be visible in 2020+



2015



2025



Satellites Launched by Application



In the last decade, the most predominant application area has been “technology,” an application loosely defined as a satellite designed to test future technologies and payloads. However, as an application, it is overtaken by the growth in EO and satcom units.

TWO DECADES OF SMALLSATS: BY APPLICATION

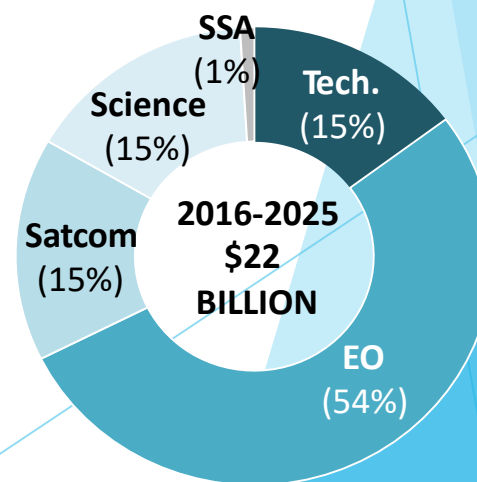
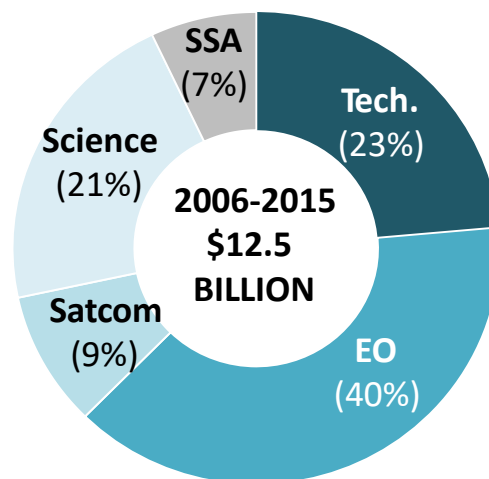
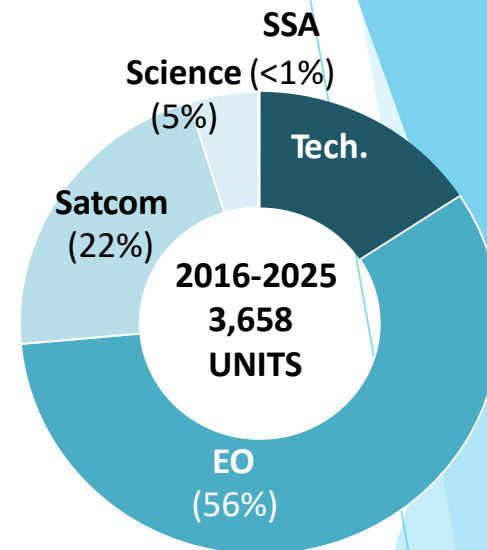
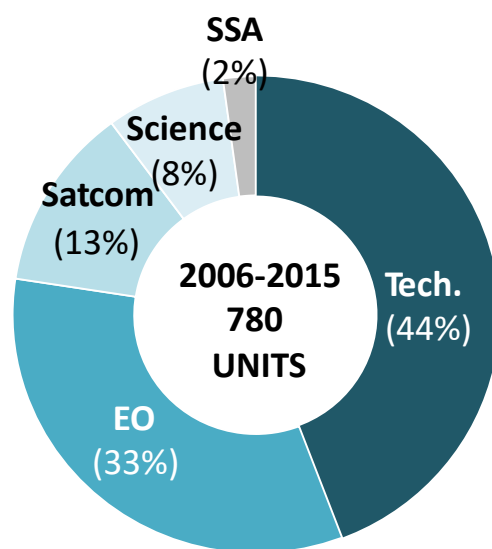



SNAPSHOT OF THE EO INDUSTRY

- 163 satellites (>50kg) launched for civil/commercial Earth observation and 31 for GEO/LEO meteorology over 2006-2015, from 35 countries
- To expand to over 400 satellites for civil Earth observation & over 50 for meteorology from 2016-2025 as further governments and commercial enterprises launch capacity
- In addition, up to 2,000 satellites <50kg , built in constellation will add to the overall supply: first constellations taking shape, some funding still required
- Majority of satellites launched from government space agencies; civil government investment topped \$10 billion for the first time in 2015
- Commercial data market totaled \$1.7 billion in 2015:
 - 5%, 5-year CAGR - defense remains the main growth driver
- Value-added services market reached \$3.2 billion in 2015
 - 11%, 5-year CAGR environment monitoring and infrastructure projects lead.



EO COMMERCIAL DATA SALES

- Commercial data market reached \$1.7 billion in 2015
- Defense markets dominate, topping \$1 billion. Reflected in the procurement of VHR data
- Defense/maritime remains first destination for SA
- Non-US defense remains most significant growth driver (11% 5-year CAGR)
- Enterprise markets gaining traction – mainly going to support VAS development
- More moderate resolution datasets starting to slow (in revenue generation) – price pressure, greater availability of lower cost solutions

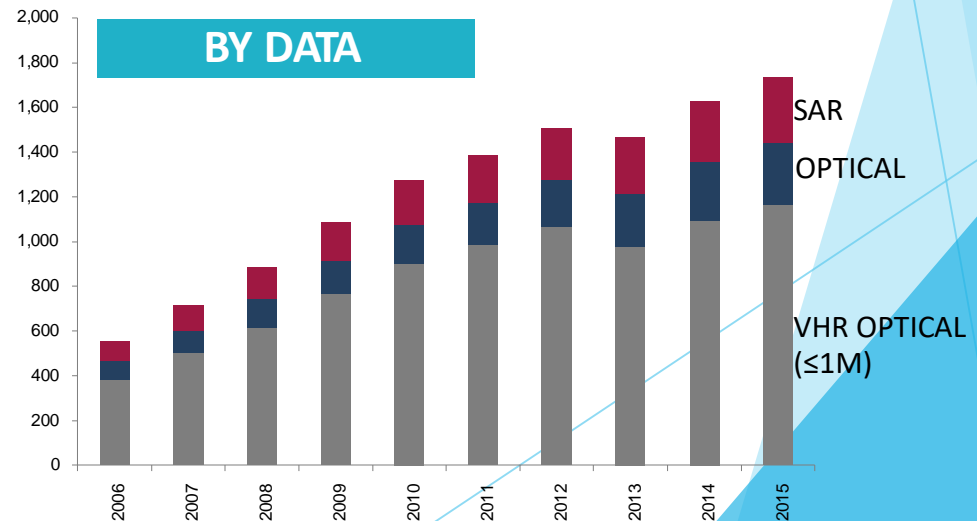
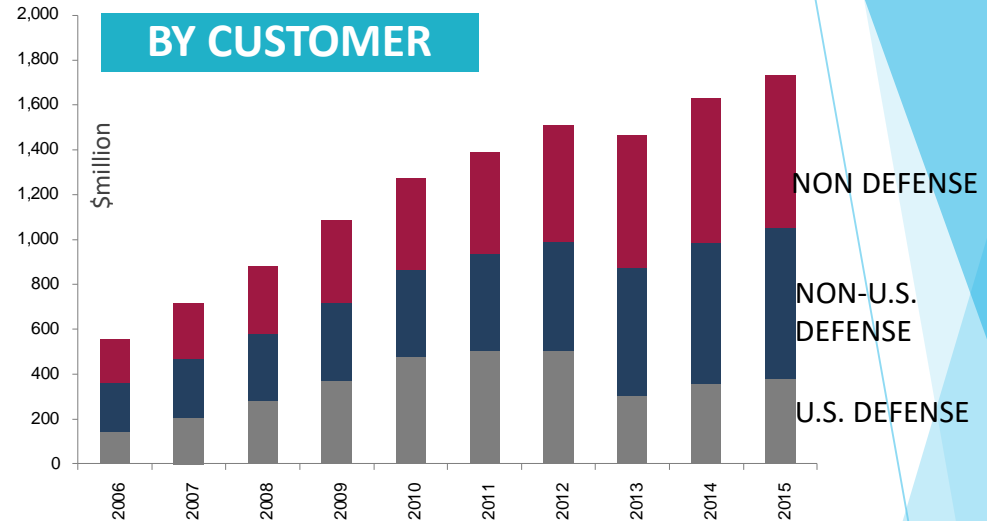



VALUE ADDED SERVICES MARKET

- Total VAS + Data market = \$4.9Bn (of which \$3.2 VAS)
- Key markets those which leverage lower-cost/free data sets
- Defense sector data sales do not translate in VAS > much work done in-house
- Current market forecast to reach \$5.3 by 2025 (5% CAGR)
- However, potential for additional service areas to open up focused on high revisit location-based application
- Uptake can be significant – though entry in to new markets a challenge

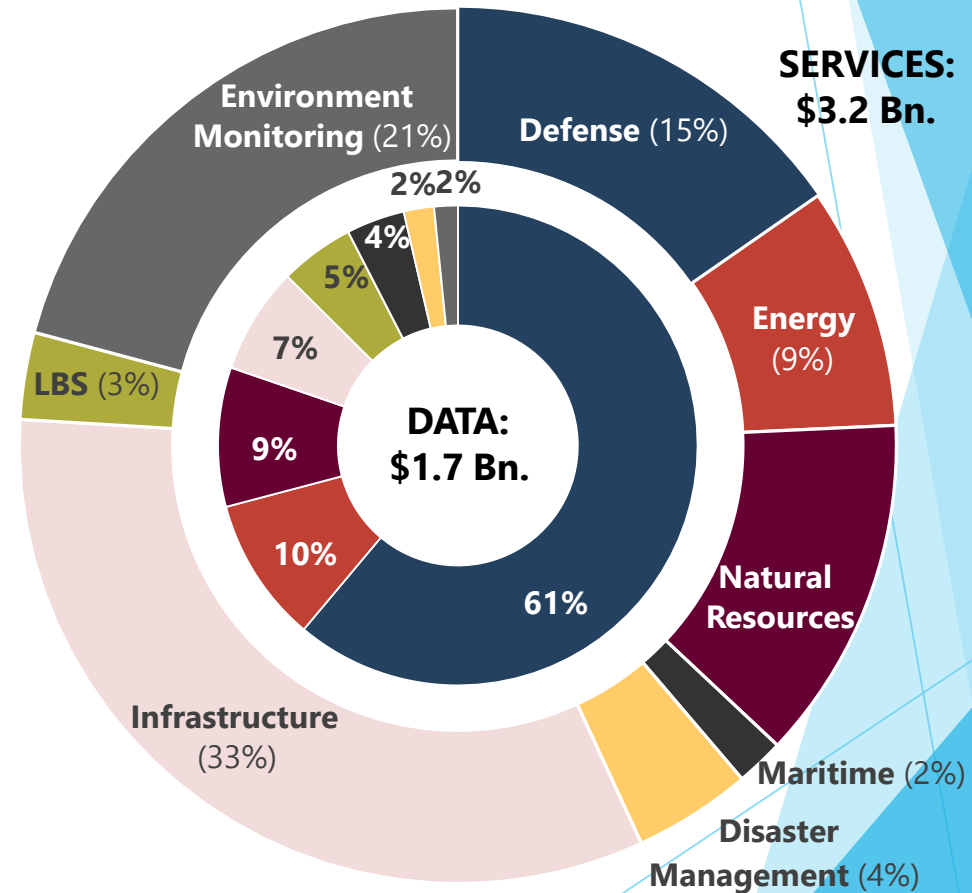



INTERNATIONAL LEADER IN THE SPACE SECTOR FOR:

Support to strategic decisions, market analysis, due diligence, independent assessments

Our missions have supported decisions on \$30b+ investment in space businesses



Most extensive research available on each level of the value chain

Interdisciplinary training on all aspects of the space industry



Promoting forward thinking, facilitating projects & deals for over 1,000 executives from 50 countries

A multi-cultural team based in France, the United States, Canada and Japan, complemented by a network of senior affiliate consultants supporting customers in more than 40 countries.

U.S.A.
4601 N Fairfax Drive, Suite 1200
Arlington, VA 22203
Tel: +1 (703) 520 6415

Sima.Fishman@Euroconsult-na.com

**Let's Eat
Bon Appetite!**

